

Baldrame  
Formas  
Concreto: C30, em geral  
Escala: 1:50

EXISTENTE - QUADRA COBERTA

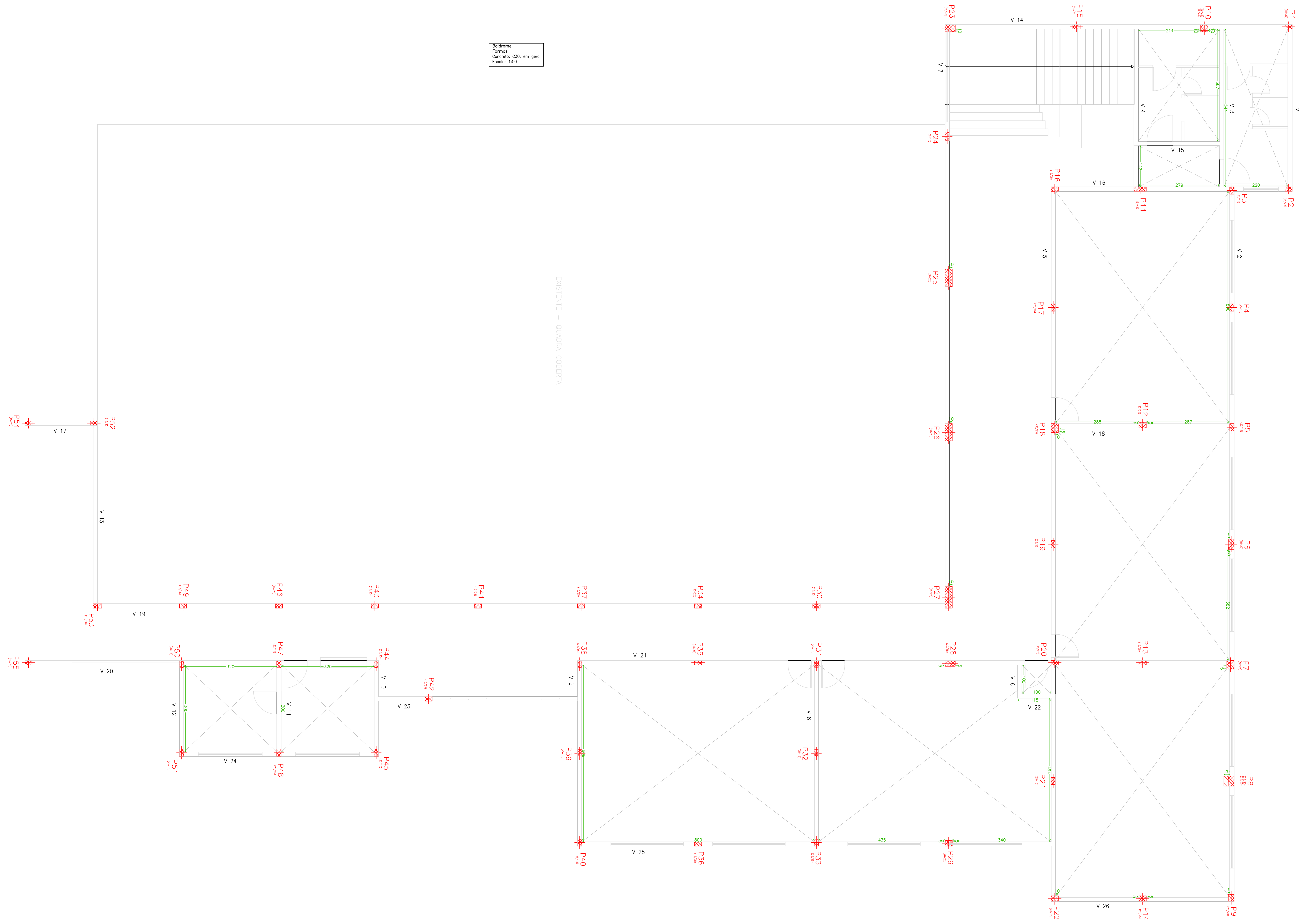

Elemento	Pos.	Diam.	O.	Deb.	Retd.	Deb.	Comp.	Total	CA-50	CA-60-B	
		(cm)		(cm)	(cm)	(cm)	(cm)	(cm)	(kg)	(kg)	
V 1	1	Ø8	10	569	10	589	1178	4.6			
	2	Ø8	10	569	10	589	1178	4.6			
	3	Ø8	10	569	10	589	1178	4.6			
Total+10%									13.8	4.9	
V 2	1	Ø8	10	840	10	850	1690	6.6			
	2	Ø8	10	840	10	850	1690	6.6			
	3	Ø8	10	840	10	850	1690	6.6			
	4	Ø8	10	840	10	850	1690	6.6			
	5	Ø8	10	840	10	850	1690	6.6			
Total+10%									33.0	20.1	
V 3	8	Ø10	12	569	12	591	1188	7.4			
	9	Ø8	10	569	10	589	1178	4.6			
	10	Ø5	3	100	100	3100					
Total+10%									12.6	5.4	
V 4	11	Ø8	10	569	10	589	1178	4.6			
	12	Ø8	10	569	10	589	1178	4.6			
	13	Ø5	3	100	100	3100					
Total+10%									13.2	5.4	
V 5	14	Ø8	10	840	10	850	1690	6.6			
	15	Ø8	10	840	10	850	1690	6.6			
	16	Ø8	10	840	10	850	1690	6.6			
	17	Ø8	10	840	10	850	1690	6.6			
	18	Ø8	10	840	10	850	1690	6.6			
Total+10%									33.0	20.6	
V 6	21	Ø8	10	125	10	145	290	1.1			
	22	Ø8	10	120	10	130	260	1.0			
	23	Ø5	3	100	100	3100					
Total+10%									2.3	1.0	
V 7	1	Ø8	10	1050	10	1050	2100	8.2			
	2	Ø8	10	620	10	630	1260	4.9			
	3	Ø8	10	395	10	410	820	3.0			
	4	Ø10	12	225	12	225	450	1.4			
	5	Ø8	10	1075	10	1075	2150	8.4			
	6	Ø8	10	620	10	630	1260	4.9			
	7	Ø12.5	15	410	15	410	820	2.5			
	8	Ø6.3	20	103	20	103	2060	5.1			
	9	Ø5	3	100	100	3100					
Total+10%									58.7	13.9	
V 8+V 9	10	Ø8	10	634	10	654	1308	5.1			
	12	Ø5	3	100	100	3200					
Total+10%									11.2	5.0	
V 10+V 11+V 12	13	Ø8	10	325	10	345	690	2.7			
	14	Ø8	10	325	10	345	690	2.7			
	15	Ø5	3	100	100	3100					
Total+10%									5.9	2.8	
V 13	16	Ø8	10	639	10	659	1318	5.2			
	17	Ø8	10	639	10	659	1318	5.2			
	18	Ø5	3	100	100	3100					
Total+10%									11.4	6.1	
V 14	1	Ø8	10	905	10	915	1830	7.2			
	2	Ø8	10	315	10	315	630	2.6			
	3	Ø8	10	905	10	915	1830	7.2			
	4	Ø8	10	315	10	315	630	2.6			
	5	Ø5	3	100	100	3200					
Total+10%									21.6	9.7	
V 15	6	Ø8	10	304	10	324	648	2.5			
	7	Ø8	10	304	10	324	648	2.5			
	8	Ø5	3	100	100	3100					
	9	Ø5	3	100	100	3200					
Total+10%									5.5	2.8	
V 16	19	Ø8	10	825	10	845	1690	6.6			
	20	Ø8	10	825	10	845	1690	6.6			
	21	Ø5	3	100	100	3100					
Total+10%									14.5	7.0	
V 17	4	Ø8	10	245	10	265	530	2.1			
	5	Ø8	10	245	10	265	530	2.1			
	6	Ø5	3	100	100	3200					
Total+10%									4.6	2.1	
V 18	1	Ø8	10	625	10	645	1290	5.1			
	2	Ø8	10	625	10	645	1290	5.1			
	3	Ø5	3	100	100	3100					
Total+10%									11.2	5.0	
V 19	1	Ø8	10	1135	10	1135	2270	8.9			
	2	Ø8	10	885	10	895	1790	7.0			
	3	Ø8	10	885	10	895	1790	7.0			
	4	Ø8	10	885	10	895	1790	7.0			
	5	Ø8	10	885	10	895	1790	7.0			
Total+10%									35.9	24.2	
V 20	8	Ø8	10	860	10	880	1760	7.0			
	9	Ø8	10	860	10	880	1760	7.0			
	10	Ø8	10	860	10	880	1760	7.0			
	12	Ø5	3	100	100	3500					
Total+10%									28.0	10.2	
V 21	13	Ø8	10	1140	10	1140	2280	8.9			
	14	Ø8	10	830	10	840	1680	6.6			
	15	Ø8	10	830	10	840	1680	6.6			
	16	Ø8	10	830	10	840	1680	6.6			
	17	Ø8	10	830	10	840	1680	6.6			
Total+10%									35.3	18.8	
V 22	20	Ø8	10	125	10	145	290	1.1			
	21	Ø8	10	120	10	130	260	1.0			
	22	Ø5	3	100	100	3100					
	23	Ø5	3	100	100	3200					
Total+10%									2.3	1.0	
V 23	23	Ø8	10	710	10	730	1460	5.7			
	24	Ø8	10	710	10	720	1440	5.7			
	25	Ø5	3	100	100	3700					
	26	Ø5	3	100	100	3700					
Total+10%									12.5	6.4	
V 24	26	Ø8	10	680	10	700	1400	5.5			
	27	Ø8	10	680	10	700	1400	5.5			
	28	Ø8	10	680	10	700	1400	5.5			
	29	Ø5	3	100	100	3600					
Total+10%									12.1	6.3	
V 25	29	Ø8	10	830	10	840	1680	6.6			
	30	Ø8	10	830	10	840	1680	6.6			
	31	Ø5	3	100	100	3800					
Total+10%									13.2	6.3	
V 26	32	Ø8	10	625	10	645	1290	5.1			
	33	Ø8	10	625	10	645	1290	5.1			
	34	Ø5	3	100	100	3100					
Total+10%									11.2	5.5	

Resumo Apo Baldrame Vigas	Comp. total (m)	Peso+10% (kg)	Total
CA-50-A Ø6.3	20.6	6	
Ø8	1007.3	435	
Ø10	14.1	10	
Ø12.5	21.0	23	474
CA-60-B Ø8	1286.0	222	222
<b>Total</b>			<b>696</b>

Baldrame - Superfície total: 37.35 m²				
Elemento	Formas (m²)	Volume (m³)	Barras (kg)	
Formas	34.48		14.87	Ø8
Ferro lateral	18.28			
Formas (Vol. Formas)	0.25	0.03	28	
<b>Total</b>	<b>52.76</b>	<b>0.03</b>	<b>14.95</b>	
Índice (por m²)	5.840	0.402	19.40	