

VISTA 2
Escala: 1:100

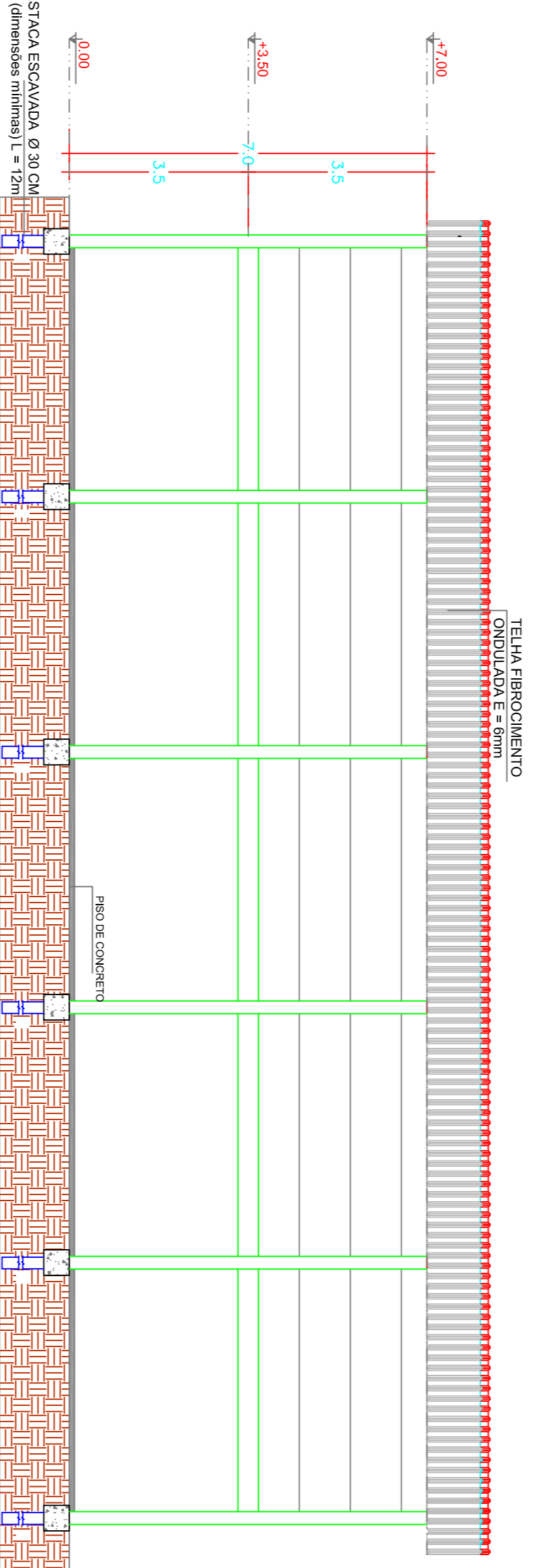

VISTA 3
Escala: 1:100

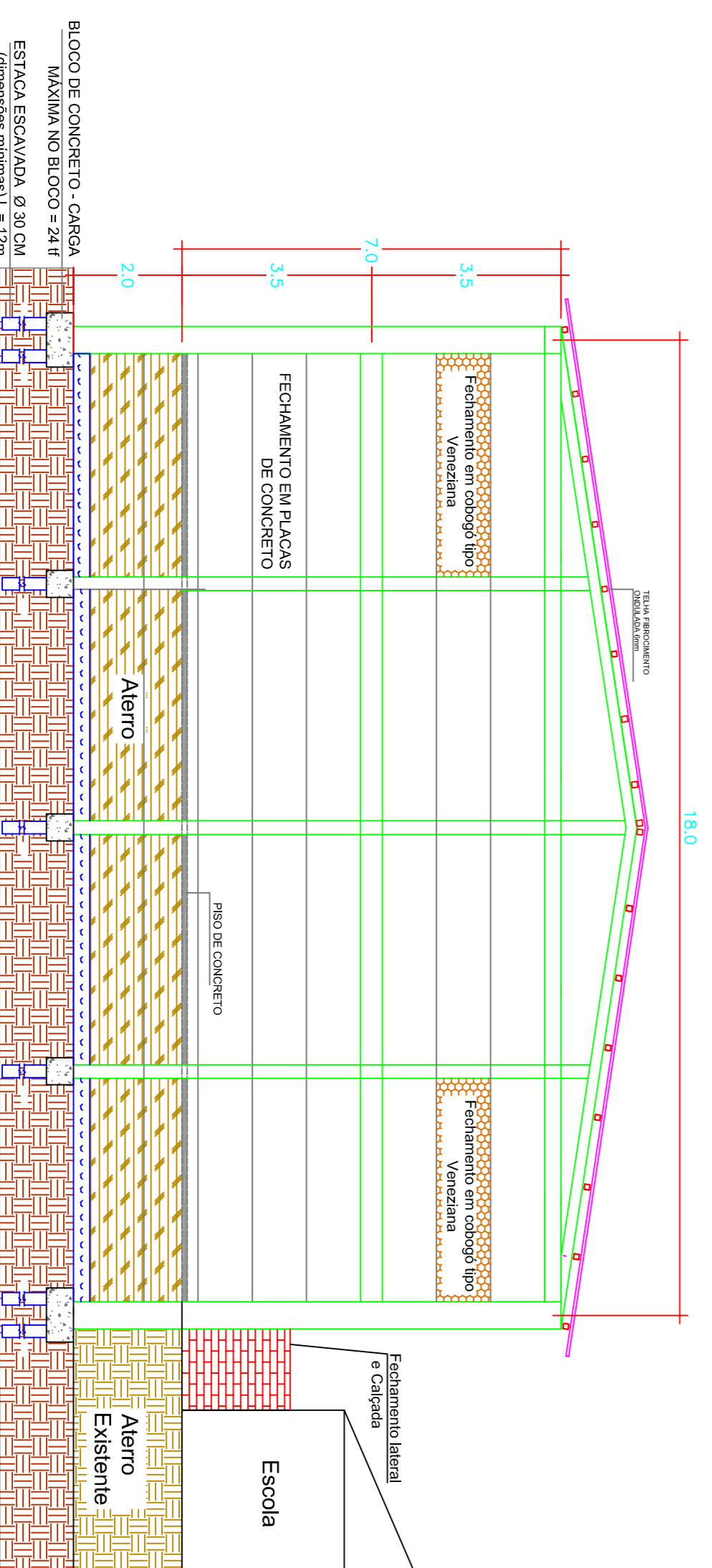

VISTA 4
Escala: 1:100

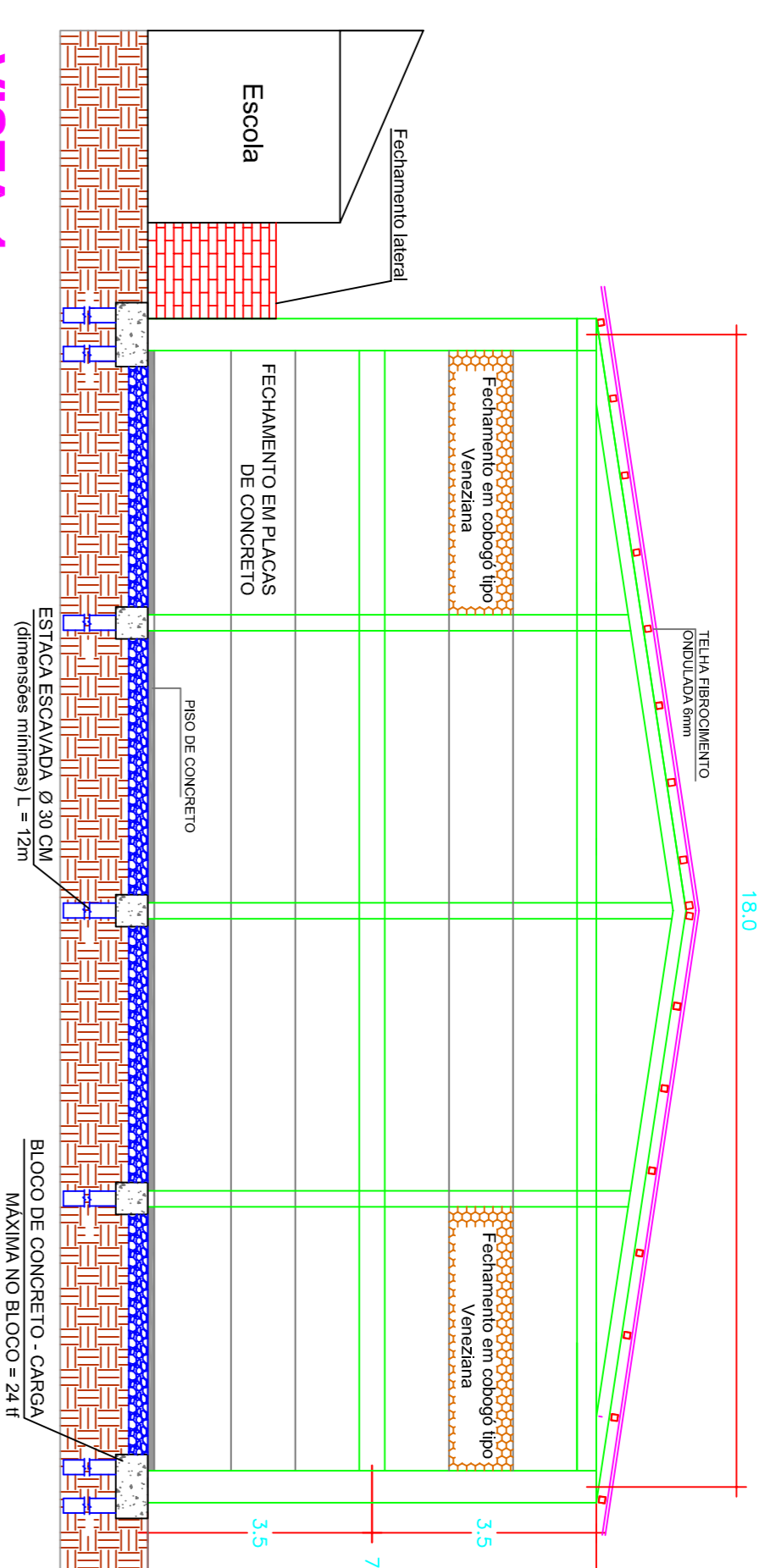

VISTA 1
Escala: 1:100

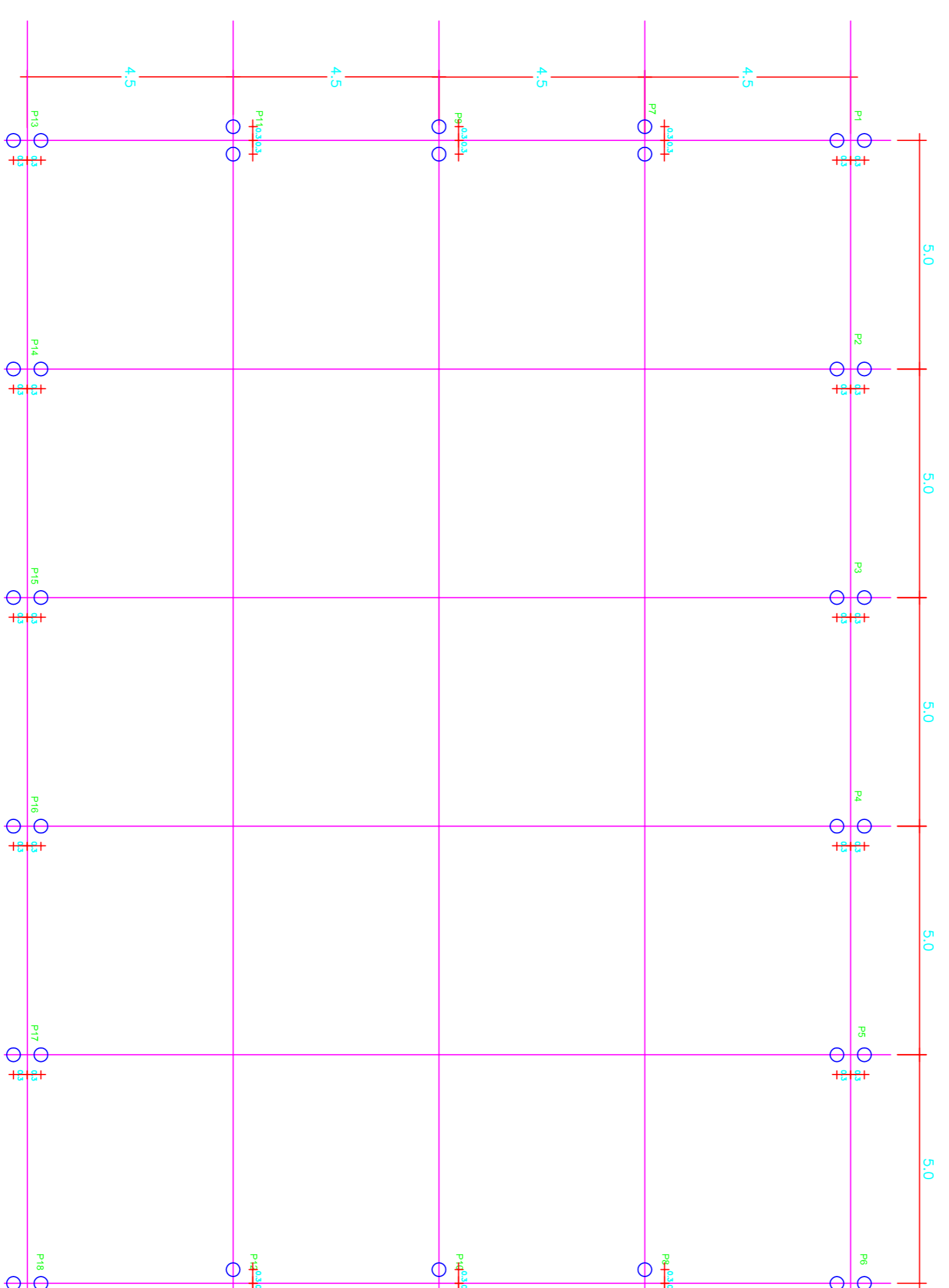

PLANTA DE LOCAÇÃO DAS ESTACAS - CENTRO DOS PILARES
Escala: 1:100

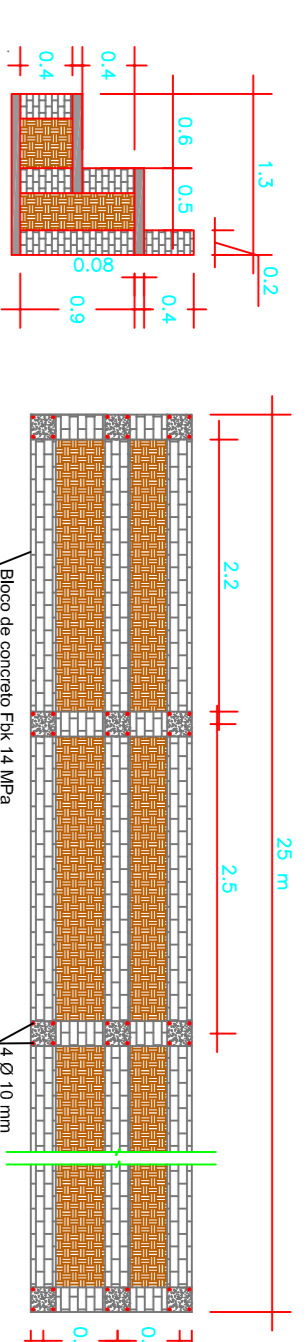

DETALHE ARQUIBANCADA
Escala: S/N

PREFEITURA MUNICIPAL DE IRINEÓPOLIS	
DATA:	17/10/2016
DESENHO:	Eng. Marcelo G. Carvalho
CONTEÚDO:	- Vistas - Locação estacas
OBRA:	Pátio coberto - G.E. Zélia Milles
ESCALA INDICADA:	FOLHA 02
Eng. Marcelo Giroto de Carvalho	CREA 134845-D/PR Visto Crea SC 129199-2

Prefeitura Municipal

Engenheiro Civil